

### SINGLE STAGE PUMPS



<u>MODEL</u>	<u>kW</u>	<u>SUCT/DISCH (mm)</u>
CMA050 (Ebara)	0.37	25/25
CMA075 (Ebara)	0.56	25/25
CMA100 (Ebara)	0.75	25/25
CMA150 (Ebara)	1.1	32/25
CMA200 (Ebara)	1.5	32/25
CMA300 (Ebara)	2.2	32/25

KM310 (Foras)	2.2	25/25
---------------	-----	-------

### SINGLE STAGE PUMPS



<u>MODEL</u>	<u>kW</u>	<u>SUCT/DISCH (mm)</u>
CMB100 (Ebara)	0.75	50/32
CMB150 (Ebara)	1.1	50/32
CMB200 (Ebara)	1.5	50/32
CMB300 (Ebara)	2.2	50/32
CMB400 (Ebara)	3.0	50/32
CMB550 (Ebara)	4.0	50/32
CMC075 (Ebara)	0.56	50/50
CMC100 (Ebara)	0.75	50/50
CMR075 (Ebara)	0.56	40/40
CMR100 (Ebara)	0.75	40/40
CMD150 (Ebara)	1.1	65/65
CMD200 (Ebara)	1.5	65/65
CMD300 (Ebara)	2.2	65/65
CMD400 (Ebara)	3.0	65/65

SE150 (Foras)	1.1	50/50
SE200 (Foras)	1.5	50/50
SE300 (Foras)	2.2	50/50

### PERIPHERAL IMPELLER



<u>MODEL</u>	<u>kW</u>	<u>SUCT/DISCH (mm)</u>
PRA050 (Ebara)	0.37	25/25
PRA100 (Ebara)	0.75	25/25
PRA150 (Ebara)	1.1	25/25
PRA200 (Ebara)	1.5	25/25

### JET PUMPS

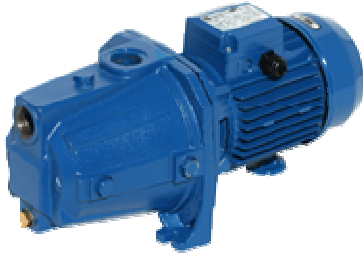

<u>MODEL</u>	<u>kW</u>	<u>SUCT/DISCH (MM)</u>
AGA100 (Ebara)	0.75	25/25
AGA150 (Ebara)	1.1	40/25
AGA200 (Ebara)	1.5	40/25
AGA300 (Ebara)	2.2	40/25
AGC150 (Ebara)	1.1	40/25
AGC200 (Ebara)	1.5	40/25
AGC300 (Ebara)	2.2	40/25

### TWO STAGE PUMPS



<u>MODEL</u>	<u>kW</u>	<u>SUCT/DISCH (MM)</u>
CDA100 (Ebara)	0.75	25/25
CDA150 (Ebara)	1.1	32/25
CDA200 (Ebara)	1.5	32/25
CDA300 (Ebara)	2.2	32/25
CDA400 (Ebara)	3.0	40/32
CDA550 (Ebara)	4.0	40/32
KBJ150 (Foras)	1.14	0/32
KBJ200 (Foras)	1.5	40/32
KBJ300T (Foras)	2.2	40/32
KB751RT (Foras)	5.5	40/32
KB1000T (Foras)	7.5	50/32
KB1500T (Foras)	11.0	50/32

**ALL SINGLE PHASE UNITS HAVE BUILT-IN OVERLOAD PROTECTION.**

**INSTALL BRASS IMPELLER  
EXTRA**

**CMA 050 / 075 & 100**

### LEADER JET PUMP WITH SCREWED CONNECTIONS

#### JET PUMPS



<u>MODEL</u>	<u>kW</u>	<u>SUCT/DISCH (MM)</u>
ECOJET 130	1.25	25/25

## HT PUMPS WITH SCREWED CONNECTIONS

### SINGLE STAGE PUMPS



<u>MODEL</u>	<u>kW</u>	<u>SUCT/DISCH (MM)</u>
MCP158-1	0.75	25/25
MCP170-1	1.1	25/25
MCP25-160A	1.5	40/25

### PERIPHERAL IMPELLER



MKP 60-1	0.37	25/25
MKP 80-1	0.75	25/25

### JET PUMPS



MJSW-10H	0.74	25/25
MJSW-3BM	1.5	32/25

### TWO STAGE PUMPS



2MCP25/140	1.1	40/25
2MCP160/160	1.5	32/25

### FLANGED PUMPS



MFM32-160B	2.2	50/32
MFM32-160A	3.0	50/32
MFM32-200B	3.0	50/32
MFM32-200A	4.0	50/32
MFM40-160B	3.0	65/40
MFM40-160A	4.0	65/40

### JET PUMPS



MJS1304S	1.3	25/25
----------	-----	-------

### HORIZONTAL MULTISTAGE PUMPS



4MCM 100S		1.1	25/25
5MCM 100S		1.3	25/25

## FORAS VERTICAL MULTI-STAGE PUMPS

### FORAS VERTICAL PLUS PUMPS



<u>MODEL</u>	<u>kW</u>	<u>SUCT/DISCH (MM)</u>
P3L-150/7	1.1	32/32
P3L-180/8	1.3	32/32
P3L-200/9	1.5	32/32
P5L-200/7	1.5	32/32
P9L-300/6	2.2	40/40
P9L-450/8T	3.3	40/40
P9L-500/9T	3.7	40/40
P18L-400/4T	3.0	50/50
P18L-450/5T	3.3	50/50
P18L-550/6T	4.0	50/50
P18L-750/8T	5.5	50/50
P18L-900/9T	6.6	50/50

### FLANGED PUMPS

### HT CAST IRON PUMPS WITH FLANGED CONNECTIONS



<u>MODEL</u>	<u>kW</u>	<u>SUCT/DISCH (MM)</u>
CM40-200B	5.5	65/40
CM40-200A	7.5	65/40
CM50-160B	5.5	65/50
CM50-160A	7.5	65/50
CM65-125B	5.5	80/65
CM65-125A	7.5	80/65

## FORAS CAST IRON PUMPS WITH FLANGED CONNECTIONS

NOTE: SEE PAGE 3 FOR HT **MFM** RANGE OF 32-160 UP TO 40-160  
&  
SEE PAGE 4 FOR HT **CM** RANGE OF 40-200 UP TO 65-125

### FLANGED PUMPS



<b>MODEL</b>	<b>kW</b>	<b>SUCT/DISCH (MM)</b>
MN32-160B	2.2	50/32
MN32-160A	3.0	50/32
MN32-200C	4.0	50/32
MN32-200B	5.5	50/32
MN32-200A	7.5	50/32
MN32-250C	9.2	50/32
MN32-250B	11.0	50/32
MN32-250A	15.0	50/32

MN40-125B	2.2	65/40
MN40-125A	3.0	65/40
MN40-160B	3.0	65/40
MN40-160A	4.0	65/40
MN40-200B	5.5	65/40
MN40-200A	7.5	65/40
MN40-250B	11.0	65/40
MN40-250A	15.0	65/40

MN50-125A	4.0	65/50
MN50-160B	5.5	65/50
MN50-160A	7.5	65/50
MN50-200C	9.2	65/50
MN50-200B	11.0	65/50
MN50-200A	15.0	65/50
MN50-250C	15.0	65/50
MN50-250B	18.5	65/50
MN50-250A	22.0	65/50

MN65-125B	5.5	80/65
MN65-125A	7.5	80/65
MN65-160B	11.0	80/65
MN65-160A	15.0	80/65
MN65-200B	18.5	80/65
MN65-200A	22.0	80/65
MN80-160A	22.0	100/80
MN80-200B	30.0	100/80

PRICES INCLUDE SCREWED C/FLANGES WITH NUTS, BOLTS & GASKETS

## ALPHA SELF-PRIMING PUMPS

### SELF PRIMING



<u>MODEL</u>	<u>kW</u>	<u>SUCT/DISCH (MM)</u>
01 ½ RAM/T	0.75	40/40
02 RASM/T	1.1	50/50
02 RAM/T	1.5	50/50
02 ½ RAT	2.2	65/65
03 RAGT	4.0	80/80
03 RAT	5.5	80/80

### BARE SHAFT PUMPS (INCLUDES PULLEY)



<u>MODEL</u>	<u>kW</u>	<u>SUCT/DISCH (MM)</u>
01 ½ RAB	Bare shaft	40/40
02 RAB	Bare shaft	50/50
02 ½ RAB	Bare shaft	65/65
03 RAB	Bare shaft	80/80
04 RAB	Bare shaft	100/100

## HT SELF-PRIMING PUMPS

### ALUMINIUM BARE SHAFT (INCLUDES PULLEY)



<u>MODEL</u>	<u>kW</u>	<u>SUCT/DISCH (MM)</u>
HZS 50B	Bare shaft	50/50

### PETROL ENGINE PUMP



<u>MODEL</u>	<u>kW</u>	<u>SUCT/DISCH (MM)</u>
WP 20X	Petrol	50/50
WP 30X	Petrol	80/80

## AISI 304 STAINLESS STEEL EBARA FLANGED PUMPS

### STAINLESS STEEL FLANGED



<u>MODEL</u>	<u>kW</u>	<u>SUCT/DISCH (MM)</u>
3MH 32-160/1.5	1.5	50/32
3MH 32-160/2.2	2.2	50/32
3MH 32-200/3.0	3.0	50/32
3MH 32-200/4.0	4.0	50/32
3MH 32-200/5.5	5.5	50/32

3MH 40-125/2.2	2.2	65/40
3MH 40-160/3.0	3.0	65/40
3MH 40-160/4.0	4.0	65/40

3MH 40-200/5.5	5.5	65/40
3MH 40-200/7.5	7.5	65/40
3MH 40-200/11.0	11.0	65/40

3MH 50-125/4.0	4.0	65/50
3MH 50-160/7.5	7.5	65/50
3MH 50-200/11.0	11.0	65/50

3MH 65-160/11.0	11.0	80/65
3MH 65-160/15.0	15.0	80/65

**3M RANGE HAS VITON SEALS FITTED AS STANDARD.**

**3MH PUMPS ARE ALL AVAILABLE IN AISI 316 L STAINLESS STEEL WITH VITON O-RINGS AND SILICON CARBIDE MECHANICAL SEALS.**

### 304 STAINLESS STEEL WITH SCREWED CONNECTIONS

#### STAINLESS STEEL



<u>MODEL</u>	<u>kW</u>	<u>SUCT/DISCH(MM)</u>
CDXH 70/05	0.37	32/25
CDXH 90/10	0.75	32/25
CDXH 120/07	0.55	32/25
CDXH 120/12	0.9	32/25
CDXH 120/20	1.5	32/25

CDXH 200/12	0.9	40/25
CDXH 200/20	1.5	40/25
CDXH 200/25	1.8	40/25

2CDXH 70/15	1.1	32/25
2CDXH 70/20	1.5	32/25

2CDXH 120/20	1.5	32/25
2CDXH 120/30	2.2	32/25
2CDXH 120/40	3.0	32/25

2CDXH 200/30	2.2	40/25
2CDXH 200/40	3.0	40/25
2CDXH 200/50	3.7	40/25

JES X M8	0.6	25/25
----------	-----	-------

#### OPEN IMPELLER



<u>MODEL</u>	<u>kW</u>	<u>SUCT/DISCH(MM)</u>
DWO 200	1.5	50/50
DWO 400T	3.0	65/50

**CDX RANGE HAS HIGH TEMPERATURE (0-110°C) VITON SEALS FITTED  
AS STANDARD.  
ALL SINGLE PHASE UNITS HAVE BUILT-IN OVERLOAD PROTECTION**



## EBARA STAINLESS STEEL AND CAST IRON SUBMERSIBLE PUMPS

### STAINLESS STEEL



<u>MODEL</u>	<u>kW</u>	<u>DISCH (MM)</u>
OPTIMA with 10M cable	0.25	32
BEST ONE with 10M cable	0.25	32
BEST ONE VOX with 10M cable	0.25	32
BEST TWO with 10M cable	0.55	40
BEST THREE with 10M cable	0.74	40
BEST FOUR with 10M cable	1.1	40
BEST FIVE with 10M cable	1.5	40

RIGHT 100 with 10M cable	0.75	40
DW 150 with 10M cable	1.1	50
DW 200 with 10M cable	1.5	50
DW 300 with 10M cable	2.2	50
DW 150 VOX with 10M cable	1.1	50
DW 200 VOX with 10M cable	1.5	50
DW 300 VOX with 10M cable	2.2	50

### SUBMERSIBLE CENTRIFUGAL MULTI-STAGE



IDROGO M40/08A with 20M cable	0.6	32
IDROGO M40/12A with 20M cable	0.9	32
IDROGO M40/15A with 20M cable	1.1	32
IDROGO M80/15A with 20M cable	1.1	32

### CAST IRON SUBMERSIBLE SEWAGE PUMP



80 DML 52.2 & 52.2 VOX	2.2	80
80 DML 54.0 & 54.0 VOX	4.0	80

100 DML 55.5 & 55.5 VOX	5.5	100
100 DML 57.5 & 57.5 VOX	7.5	100
100 DML 511.0 & 511.0 VOX	11.0	100
100 DML 515.0 & 515.0 VOX	15.0	100
100 DML 522.0 & 522.0 VOX	22	100

150 DML 55.5	5.5	150
150 DML 57.5	7.5	150
150 DML 511.0	11.0	150
150 DML 515.0	15.0	150
150 DML 522.0	22.0	150

## FORAS CAST IRON SUBMERSIBLE PUMPS

### CAST IRON SUBMERSIBLE WITH GRINDER

<u>MODEL</u>	<u>kW</u>	<u>DISCH (MM)</u>
FTR 150 GRINDER	1.1	50
FTR 200 GRINDER	1.5	50
FTR 300 GRINDER	2.2	50



**220V UNITS INCLUDE FLOAT SWITCH.  
380V UNITS DO NOT HAVE FLOAT SWITCH.**

## HT CAST IRON SUBMERSIBLE PUMPS

### CAST IRON SUBMERSIBLE WATER PUMP



<u>HT</u>	<u>kW</u>	<u>DISCH</u>	
V180F	0.18	32	10M cable with float switch
V250F	0.25	32	10M cable with float switch
V550AF	0.55	50	10M cable with float switch
V750F	0.75	50	10M cable with float switch
V750	0.75	50	10M cable no float switch
V2200F	2.2	75	10M cable with float switch
V2200	2.2	75	10M cable no float switch
SPA750MF	0.75	40	10M cable with float switch
V1300DF	1.3	50	10M cable with float switch
V1300D	1.3	50	10M cable no float switch
V1800DF	1.8	75	10M cable with float switch

## SUBMERSIBLE PUMPS FOR DEWATERING

### SUBMERSIBLE



<u>LEADER</u>	<u>kW</u>	<u>DISCH</u>	
ECOSUB 400	0.22	32	10m cable (no float)
SUPERPOND 450	0.28	32	10m cable (no float)
SUPERPOND 460	0.75	32	10m cable (no float)



SUPERSUB 450A	0.28	32	10m cable incl float switch
SUPERSUB 460A	0.75	32	10m cable incl float switch



VERTYGO 300	0.3	32	10m cable with auto/duty selector
ECODIVER 1200A	1.1	25	20m cable multistage incl f/switch

### WATER PUMP



ECOVORT 520A	0.65	32	10m cable incl float switch
BVP	1.0	40	10m cable incl float switch

### HT FOUNTAIN PUMP



<u>MODEL</u>	<u>WATT</u>	<u>MAX HEAD</u>	<u>MAX FLOW</u>
HJ541	5	0.8 MT	400 LT/H
HJ741	8	1.0 MT	600 LT/H
HJ941	16	1.3 MT	800 LT/H
HJ1141	22	1.6 MT	1000 LT/H
HJ1541	28	2.0 MT	1400 LT/H
HJ1841	40	2.5 MT	1800 LT/H



HQB2500	55	2.5 MT	2000 LT/H
HQB3500	85	3.5 MT	3000 LT/H
HQB4500	100	4.5 MT	4500 LT/H
HQB5000	150	5.0 MT	5500 LT/H
HQB5500	200	5.5 MT	6800 LT/H

### PONDMASTER



<u>MODEL</u>	<u>WATT</u>	<u>MAX HEAD</u>	<u>MAX FLOW</u>
PONDMASTER 8 500	330	7.0MT	8500 LT/H
PONDMASTER 13 000	420	7.5MT	13000 LT/H

### Jet Kits

JET KIT - HQB -CFA-03
JET KIT - HJ -CFA-05

## EXPANSION TANKS WITH BUTYLE MEMBRANES

### ZILMET EXPANSION TANKS



<u>MODEL</u>
8 LITRE HY-PRO TANK
24 LITRE HYDROSPHERE
24 LITRE HYDROPRO fixed membrane
24 LITRE HYDROTUBE
60 LITRE HORIZONTAL
60 LITRE VERTICAL
100 LITRE HORIZONTAL
100 LITRE VERTICAL
200 LITRE VERTICAL
300 LITRE VERTICAL 10 BAR
500 LITRE VERTICAL 10 BAR
<b>300 LITRE VERTICAL H.P. 16 BAR</b>
<b>500 LITRE VERTICAL H.P. 16 BAR</b>

## ACCESSORIES

<u>PRESSURE GAUGES</u>	<u>DETAILS</u>
0-600 KPA	63MM DIAL DRY BOTTOM ENTRY
0-1200 KPA	63MM DIAL DRY BOTTOM ENTRY
0-600 KPA	63MM DIAL GLYCERINE FILLED BOTTOM ENTRY
0-1000 KPA	63MM DIAL GLYCERINE FILLED BOTTOM ENTRY

<u>PRESSURE SWITCHES</u>	<u>DETAILS</u>
0-600 KPA	SQUARE D LOW PRESSURE TYPE FSG-2
0-1200 KPA	SQUARE D MED PRESSURE TYPE FYG-22
0-1500 KPA	SQUARE D HIGH PRESSURE TYPE FYG-32

### BRAIDED FLEXIBLE HOSES



<u>DETAILS</u>
25MM DIA X 500MM LONG C/W GASKET & UNION
25MM DIA X 1000MM LONG C/W GASKET & UNION
40MM DIA X 800MM LONG C/W GASKET & UNION
BRASS 3-WAY CONNECTOR SHORT
BRASS 5-WAY CONNECTOR LONG

## ACCESSORIES CONTINUED

### NON-RETURN VALVES

15MM BRASS
20MM BRASS
25MM BRASS
32MM BRASS
40MM BRASS
50MM BRASS
65MM BRASS
80MM BRASS
100MM BRASS

### FLOAT SWITCH, NEOPRENE CABLE

5 METRE CABLE WITH COUNTERWEIGHT
10 METRE CABLE WITH COUNTERWEIGHT

### HT ELECTRONIC PUMP CONTROLS



Size	MODEL	Max amp
"1"	PS-01 NO GAUGE NON ADJUSTABLE	10amp
"1 1/4"	PS-01A NO GAUGE NON ADJUSTABLE	30amp

"1"	PS-02A WITH GAUGE NON ADJUSTABLE	10amp
"1"	PS-02B WITH GAUGE ADJUSTABLE	10amp

## EBARA AND FORAS SINGLE PRESSURE BOOSTER SYSTEMS



<u>MODEL/TANK SIZE</u>	<u>CAPACITY (LT/MIN)</u>	<u>kW</u>	<u>OPERATING PRESS (kPa)</u>
PRA050/24	29	0.37	140/350
PRA100/24	52	0.75	200/500

AGA100/24	58	0.75	250/450
AGA150/60	90	1.1	300/450
AGA200/60	90	1.5	400/600
AGA300/100	90	2.2	500/700

AGC150/100	160	1.1	150/350
AGC200/100	160	1.5	260/480
AGC300/100	160	2.2	320/570

KBJ200/100	160	1.5	260/430
KBJ300/100	170	2.2	340/480

CMA100/60	108	0.75	200/340
CMA150/100	125	1.1	280/410
CMA200/100	130	1.5	340/490



CDA100/24	90	0.75	200/400
CDA150/60	100	1.1	300/520
CDA200/100	115	1.5	350/600
CDA300/100	155	2.2	350/650
CDA400/200	190	3.0	450/680
CDA550/300	200	4.0	550/780

CMB200/500	270	1.5	230/300
CMB300/500	270	2.2	290/360
CMB400/500	270	3.0	350/460
CMB550/500	270	4.0	490/580

**SYSTEMS ARE COMPLETE WITH PUMP, TANK, INTERCONNECTING PIPEWORK, BALL AND NON-RETURN VALVES, PRESSURE SWITCH & PRESSURE GAUGE, FULLY WIRED, TESTED, READY FOR OPERATION. SINGLE PHASE UNITS INCORPORATE THERMAL OVERLOAD PROTECTION BUILT INTO MOTOR, THREE PHASE UNITS HAVE STARTER UNITS WITH OVERLOAD.**

## FORAS PLUS RANGE MULTISTAGE BOOSTER SYSTEMS



<u>MODEL/TANK SIZE</u>	<u>CAPACITY (LT/MIN)</u>	<u>kW</u>	<u>OPERATING PRESS (kPa)</u>
P3L-150/7/60	75	1.1	350/750
P3L-180/8/60	75	1.3	450/850
P3L-200/9/60	75	1.5	550/950
P5L-200/7/100	120	1.5	320/700
P9L-300/6/200	200	2.2	320/650
P9L-450/8/200	200	3.3	500/900
P9L-500/9/300 <b>16 BAR</b>	200	3.7	600/1000
P18L-400/4/300	350	3.0	250/450
P18L-450/5/300	350	3.3	300/550
P18L-550/6/300	350	4.0	370/650
P18L-750/8/300	350	5.5	600/900
P18L-900/9/300 <b>16 BAR</b>	350	6.6	700/1000

**SYSTEMS ARE COMPLETE WITH PUMP, TANK, INTERCONNECTING PIPEWORK, BALL AND NON-RETURN VALVES, PRESSURE SWITCH & PRESSURE GAUGE, FULLY WIRED, TESTED, READY FOR OPERATION. SINGLE PHASE UNITS INCORPORATE THERMAL OVERLOAD PROTECTION BUILT INTO MOTOR, THREE PHASE UNITS HAVE STARTER UNITS WITH OVERLOAD.**

## HT SINGLE PRESSURE BOOSTER SYSTEMS



<u>MODEL</u>	<u>CAPACITY (LT/MIN)</u>	<u>kW</u>	<u>OPERATING PRESS (kPa)</u>
MKP60-1/24	30	0.37	140/350
MKP80-1/24	45	0.75	250/500
MJSW-10H/24	48	0.75	220/450
MJS1304SA3/20	53	1.3	220/440
MJSW-3BH/60	75	1.5	400/500
4MCM 100S/24	75	1.1	220/420
5MCM 100S/24	75	1.3	320/520

**SYSTEMS ARE COMPLETE WITH PUMP, TANK, INTERCONNECTING PIPEWORK, BALL AND NON-RETURN VALVES, PRESSURE SWITCH & PRESSURE GAUGE, FULLY WIRED, TESTED, READY FOR OPERATION. SINGLE PHASE UNITS INCORPORATE THERMAL OVERLOAD PROTECTION BUILT INTO MOTOR, THREE PHASE UNITS HAVE STARTER UNITS WITH OVERLOAD.**

## EBARA AND HT ELECTRONIC BOOSTER SYSTEMS



<u>MODEL</u>	<u>CAPACITY (LT/MIN)</u>	<u>kW</u>	<u>OPERATING PRESS (kPa)</u>		
AGA/100/PS01	58	0.75	250/450	R5,180	--
4MCM 100S/PS01	75	1.1	220/420	R3,770	--
5MCM 100S/PS01	75	1.3	320/520	R3,940	--
CDA100/PS01	90	0.75	200/400	R5,450	--
MCP158/PS01	95	0.75	200/300	R3,570	--
CMA100/PS01	108	0.75	200/340	R4,140	--

### VARIABLE SPEED DRIVES



<u>MODEL</u>	
VASCO 214 3.0kW 1/220V	14A
VASCO 409 4.0kW 3/380V	9A
VASCO 411 5.5kW 3/380V	11A
VASCO 418 7.5kW 3/380V	11A
VASCO 425 11kW 3/380V	25A

### DANFOS PRESSURE TRANSDUCER



<u>MODEL</u>	
DANFOS PRESSURE TRANSDUCER	16BAR 4-20MA

### WALL MOUNT KIT    MOTOR MOUNT KIT

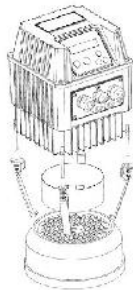
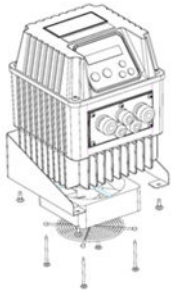

<u>MODEL</u>
VASCO 214
VASCO 409
VASCO 411
VASCO 418/425

**VASCO IS A VARIABLE FREQUENCY DRIVE DESIGNED TO CONTROL AND PROTECT PUMPING SYSTEMS BY VARYING THE OUTPUT FREQUENCY TO THE PUMP. VASCO UNITS CAN BE INSTALLED TO BOTH NEW AND EXISTING PUMPING SYSTEMS. WHEN CONNECTED TO ANY PUMP, MANAGES THE SYSTEM OPERATION TO MAINTAIN A CERTAIN PHYSICAL QUANTITY, (PRESSURE/FLOW/TEMPERATURE), REGARDLESS OF THE CONDITIONS OF USE. THE PUMP IS OPERATED ONLY WHEN NEEDED THUS AVOIDING UNNECESSARY ENERGY CONSUMPTION**



<b>MODEL NUMBER/TANK SIZE</b>	<b>KW PER PUMP</b>	<b>CAPACITY PER PUMP (LT/MIN)</b>	<b>TOTAL CAPACITY (LT/MIN)</b>
TWIN CMA150/100	1.1	110	220
TWIN CMA200/100	1.5	125	250
TWIN AGA200/100	1.5	95	190
TWIN AGC200/100	1.5	160	320
TWIN CDA150/60	1.1	95	190
TWIN CDA200/100	1.5	100	200
TWIN CDA300/100	2.2	130	260
TWIN KBJ300/200	2.2	170	340
TWIN CDA400/200	3.0	180	360
TWIN CDA550/200	4.0	200	400
TWIN P3L-150/7/60	1.1	75	150
TWIN P3L-180/8/60	1.3	75	150
TWIN P3L-200/9/60	1.5	75	150
TWIN P5L-200/7T/100	1.5	120	240
TWIN P9L-300/6T/200	2.2	200	400
TWIN P9L-450/8T/200	3.3	200	400
TWIN P9L-500/9T/200	3.7	200	400
TWIN P18L-400/4T/300	3.0	350	700
TWIN P18L-450/5T/300	3.3	350	700
TWIN P18L-550/6T/300	4.0	350	700
TWIN P18L-750/8/300	5.5	350	700
TWIN P18L-900/9/300	6.6	350	700



**40 years of experience in the design and manufacture of twin pump pressure systems.**

**Fully packaged systems supplied complete with two pumps mounted on a common base-frame and coupled to one free-standing expansion vessel. All units have STEEL inlet and outlet manifolds incorporating isolating and non return valves. Each unit is pre-wired, tested and ready for automatic operation. (Phase failure relay incorporated as standard)**

**100% standby against pump or motor failure. This results in 200% of design flow available to cater for peak or extraordinary demand.**

**Prices are ex-works Johannesburg. These systems are manufactured to order, please allow 15-21 working days from date of official order.**

**Terms and conditions apply.**